Photograph requirements

The photograph submitted with each application should meet the following requirements.

Examples of both appropriate and inappropriate photographs have been provided for reference, so please ensure that all submissions meet the standards.

- Photograph size 4 cm long, 3 cm wide
- The photograph must contain only the applicant.
- The dimensions of the photograph must meet those shown on the left (excluding the edges).

(The dimensions of the face are measured from the top of the subject's head (including their hair) to the tip of their chin.)

- The applicant must face the camera and cannot wear a hat.
- There must be no background (including no shadow).
- It must be a clear photograph.
- It must be taken within three months of the date of submission.
- The applicant's name must be written on the back.

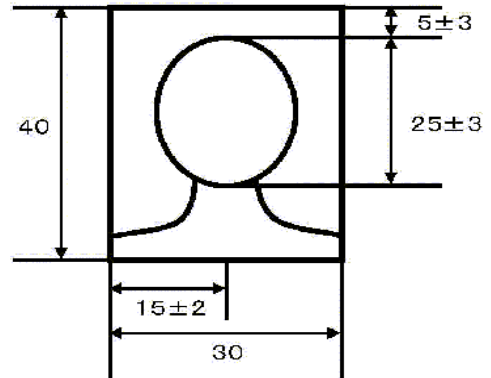

Examples of appropriate photographs

These photographs meet all of the requirements listed above and show the subject clearly.



Examples of inappropriate photographs

Photographs that do not meet the specifications listed above.



Subject is not centered



Subject's face is turned



Shadows in the background



Subject is leaning

(“Photograph requirements” was prepared by aile academy with some content edited from the source “Photograph requirements” on the website of the Immigration Services Agency of Japan.)